

B162.118.303.155N

T-MOTION SPRING

Material Information;

Rod: Ø6 | Tube: Ø15

Rod Material | Surface: C35 STEEL | BLACK NITRATED

Tube Material | Surface: STEEL | BLACK PAINTED

Rod Side Conn. Material | Surface: Steel | Zinc Plated

Tube side Conn. Material | Surface: Steel | Black Painted

Functional Instructions;

Dampening Period: St

Opening Speed: St

Tolerances;

L: +2 / -2

S: +5 / -2

F1: +23N / -7N

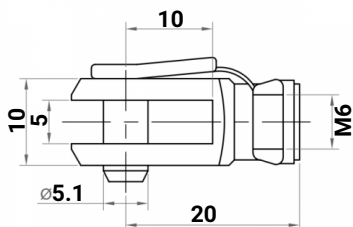

Type	R. Conn.	T. Conn.	Stroke	Length	F1
S15	FC13	K002	118	303	155N

A.PiERiNGER
www.ap.co.at | www.ap.cool | www.ap.works

