

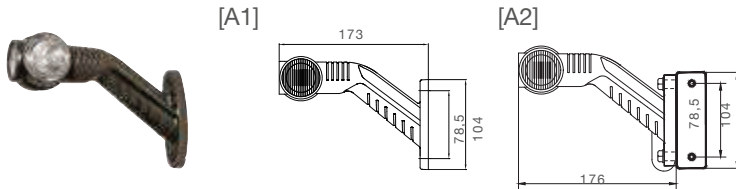

SUPERPOINT III LED

ADR Zone 2 IP69K



A.PiERiNGER GmbH
www.ap.works

2141 Ameis, Obere Hauptstraße 68
Telefon: +43 / 2425 / 278 00
E-Mail: vk@ap.co.at

Umrissleuchte
End outline marker

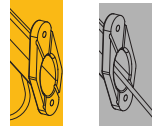

BEST. NR						ZUSATZ	ANSCHLUSS		
PART NO						ADD ON	CONNECTOR		
31-3365-094	1/-	●		LED	24V	[A2]	2 pol. ASS2 2 pin ASS2	♀	1,50 m
31-3366-094	1/-		●	LED	24V	[A2]	2 pol. ASS2 2 pin ASS2	♀	1,50 m
31-3300-074	1/-	●	●	LED	24V	[A1]	offenes Ende open end		4,00 m
31-3302-054	1/-	●		LED	24V	[A1]	2 pol. Superseal 2 pin Superseal	♀	0,50 m
31-3303-054	1/-		●	LED	24V	[A1]	2 pol. Superseal 2 pin Superseal	♀	0,50 m
31-3304-044	1/-	●		LED	24V	[A1]	P&R		1,25 m
31-3304-054	1/-		●	LED	24V	[A1]	P&R		1,25 m
31-3304-114	1/-		●	LED	24V	[A1]	P&R		1,25 m
31-3304-124	1/-	●		LED	24V	[A1]	P&R		1,25 m
31-3304-134	1/-		●	LED	24V	[A1]	P&R		1,75 m
31-3304-144	1/-	●		LED	24V	[A1]	P&R		1,75 m
31-3305-014	1/-	●		LED	24V	[A1]	2 pol. ASS2 2 pin ASS2	♀	1,75 m
31-3305-044	1/-	●		LED	24V	[A1]	2 pol. ASS2 2 pin ASS2	♀	2,00 m
31-3305-124	1/-	●		LED	24V	[A1]	3 pol. ASS3 3 pin ASS3	♀	1,25 m
31-3305-214	1/-	●		LED	24V	[A1]	2 pol. ASS2 2 pin ASS2	♀	0,50 m
31-3305-294	1/-	●		LED	24V	[A1]	2 pol. Superseal 2 pin Superseal	♂	0,50 m
31-3306-014	1/-		●	LED	24V	[A1]	2 pol. ASS2 2 pin ASS2	♀	1,50 m

ERSATZTEILE | SPARE PARTS



SUPERPOINT III LED

ADR Zone 2 IP69K



Umrissleuchte
End outline marker

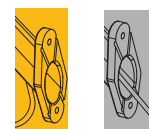

BEST. NR						ZUSATZ				ANSCHLUSS					
PART NO						ADD ON				CONNECTOR					
31-3306-044	1/-		●	LED	24V	[A1]				2 pol. ASS2 2 pin ASS2	♀			2,00 m	
31-3306-124	1/-		●	LED	24V	[A1]				3 pol. ASS3 3 pin ASS3	♀			1,25 m	
31-3306-214	1/-		●	LED	24V	[A1]				2 pol. ASS2 2 pin ASS2	♀			0,50 m	
31-3306-294	1/-		●	LED	24V	[A1]				2 pol. Superseal 2 pin Superseal	♂			0,50 m	
31-3362-004	1/-		●	LED	24V	[B]				2 pol. Superseal 2 pin Superseal	♀			0,25 m	
31-3362-104	1/-		●	LED	24V	[B]				2 pol. Superseal 2 pin Superseal	♂			1,50 m	
31-3363-004	1/-	●		LED	24V	[B]				2 pol. Superseal 2 pin Superseal	♀			0,25 m	
31-3363-104	1/-	●		LED	24V	[B]				2 pol. Superseal 2 pin Superseal	♂			1,50 m	
31-3364-024	1/-		●	LED	24V	[B]				P&R				1,50 m	
31-3364-054	1/-	●		LED	24V	[B]				P&R				1,50 m	
31-3365-014	1/-	●		LED	24V	[B]				offenes Ende open end				4,00 m	
31-3365-054	1/-	●		LED	24V	[B]				2 pol. ASS2 2 pin ASS2	♀			0,25 m	
31-3365-064	1/-	●		LED	24V	[B]				3 pol. ASS3 3 pin ASS3	♀			1,50 m	
31-3366-024	1/-		●	LED	24V	[B]				offenes Ende open end				4,00 m	
31-3366-054	1/-		●	LED	24V	[B]				2 pol. ASS2 2 pin ASS2	♀			0,25 m	
31-3366-064	1/-		●	LED	24V	[B]				3 pol. ASS3 3 pin ASS3	♀			1,50 m	
31-3305-084	1/-	●		LED	24V	[C]				offenes Ende open end				0,04 m	
							Europoint II								
31-3306-084	1/-		●	LED	24V	[C]				offenes Ende open end				0,04 m	
							Europoint II								



SUPERPOINT III LED

ADR Zone 2 IP69K

[D]

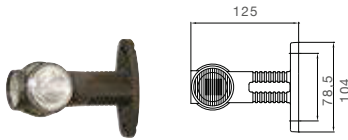

[E]

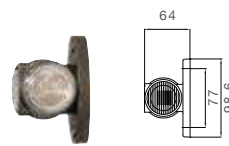

Umrissleuchte
End outline marker

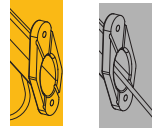

BEST. NR						ZUSATZ				ANSCHLUSS	
PART NO						ADD ON				CONNECTOR	
31-3300-244	1/-	●	●	LED	24V	[D]				offenes Ende open end	4,00 m
31-3302-064	1/-		●	LED	24V	[D]				2 pol. Superseal 2 pin Superseal	♀ 0,50 m
31-3303-064	1/-	●		LED	24V	[D]				2 pol. Superseal 2 pin Superseal	♀ 0,50 m
31-3304-094	1/-	●	●	LED	24V	[D]				P&R	1,25 m
31-3305-194	1/-	●		LED	24V	[D]				2 pol. ASS2 2 pin ASS2	♀ 2,00 m
31-3306-194	1/-		●	LED	24V	[D]				2 pol. ASS2 2 pin ASS2	♀ 2,00 m
31-3307-014	1/-	●	●	LED	24V	[D]				2 pol. ASS2 2 pin ASS2	♀ 1,75 m
31-3307-024	1/-	●	●	LED	24V	[D]				3 pol. ASS3 3 pin ASS3	♀ 1,75 m
31-3307-104	1/-	●	●	LED	24V	[D]				2 pol. ASS2 2 pin ASS2	♀ 2,50 m
31-3307-194	1/-	●	●	LED	24V	[D]				2 pol. Superseal 2 pin Superseal	♂ 2,00 m
31-3300-374	1/-	●	●	LED	24V	[E]				2 pol. Superseal 2 pin Superseal	♀ 3,00 m
31-3307-044	1/-	●	●	LED	24V	[E]				2 pol. ASS2 2 pin ASS2	♀ 1,50 m
31-3307-134	1/-	●	●	LED	24V	[E]				2 pol. ASS2 2 pin ASS2	♀ 3,00 m
31-3307-224	1/-	●	●	LED	24V	[E]				3 pol. ASS3 3 pin ASS3	♀ 0,50 m
31-3360-004	1/-	●	●	LED	24V	[E]				offenes Ende open end	4,00 m
31-3364-004	1/-	●	●	LED	24V	[E]				P&R	1,50 m
31-3367-004	1/-	●	●	LED	24V	[E]				2 pol. ASS2 2 pin ASS2	♀ 0,50 m



SUPERPOINT III LED

ZUBEHÖR / ACCESSORIES

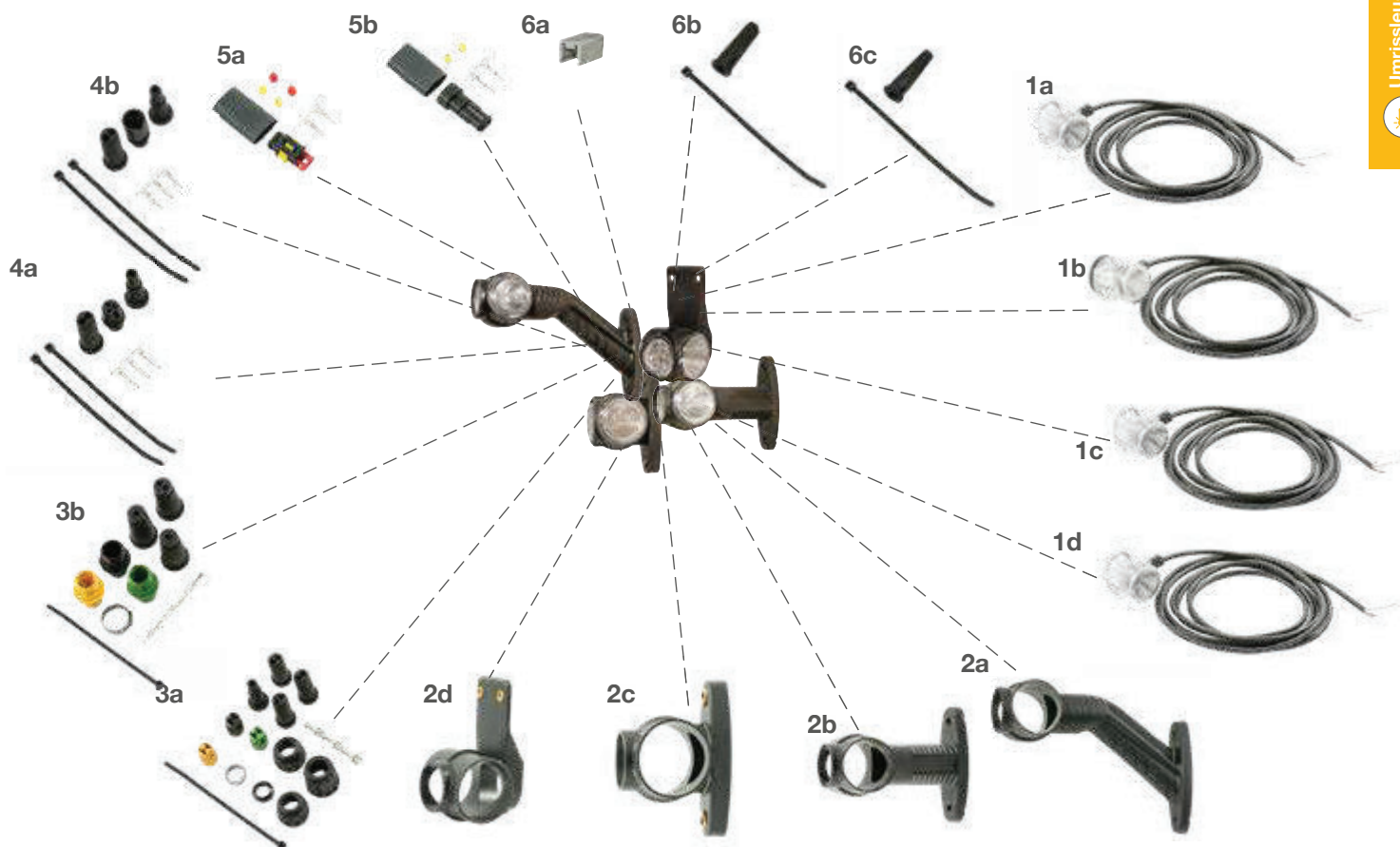

1 Lichtscheibe | lens

- (a) rot/weiß/orange mit 4,00 m Kabel
red/white/orange with 4,00 m cable 21-3351-704
- (b) schwarz/weiß/orange mit 4,00 m Kabel
black/white/orange with 4,00 m cable 21-3350-704
- (c) rot/weiß/orange mit 1,50 m Kabel
red/white/orange with 1,50 m cable 21-3353-704
- (d) rot/weiß/orange mit 3,00 m Kabel
red/white/orange with 3,00 m cable 21-3354-704

2 Umrissarm | end outline marker

- (a) Standard
Standard..... 21-3300-007
- (b) gerade
straight 21-3302-007
- (c) Direktanbau
direct mounting 15-5325-004
- (d) mit Pendelhalter
with pendular bracket.. 15-5325-101

3 ASS1 & ASS2 Verbinder | ASS1 & ASS2 connector

- (a) 2 pol. weiblich
2 pin female 13-5626-401
- (b) 2 pol. männlich
2 pin male 13-5625-991

4 ASS3 Verbinder | ASS3 connector

- (a) 3 pol. weiblich
3 pin female 13-0322-281
- (b) 3 pol. männlich
3 pin male 13-0332-281

5 Superseal Verbinder | Superseal connector

- (a) 2 pol. weiblich
2 pin female 15-7002-044
- (b) 2 pol. männlich
2 pin male 15-7002-054

6 für P&R Verbinder | for P&R connector

- (a) Verschlusskappen
caps..... 15-5971-014
- (b) Endkappen rund
end caps round..... 15-5983-024
- (c) Endkappen eckig
end caps square..... 15-5729-014